

Looking for a Plot / Site Plan of your Property?

The City of Fishers has some residential plot plans for various subdivisions digitally on file. Plot Plans on file are available through the online permitting software, OpenGov at no cost. You do not need to make an OpenGov account to access the file.

Note: Improvements within easements will require approval of the appropriate utility companies.

1

Go to www.fishersin.gov/plotplan which will redirect you to our online permitting software, OpenGov.

2

Click the link to the "Search" feature. A window that says "Search for Public Records" will open. Start typing in your address and addresses will begin to populate. Once you see your address, go ahead and click on it.

3

If the City has the Plot Plan or Site Plan record on file, it will be located under the Record Type "Residential Plot Plan Request" or "Residential Building Permit". Click on that Record Type.

4

Under "Attachments" any Plot Plans or Site Plans on record will be available as an PDF or TIF document. Click the "File Name" and click "Download". You will then be prompted to save the Document to your computer.

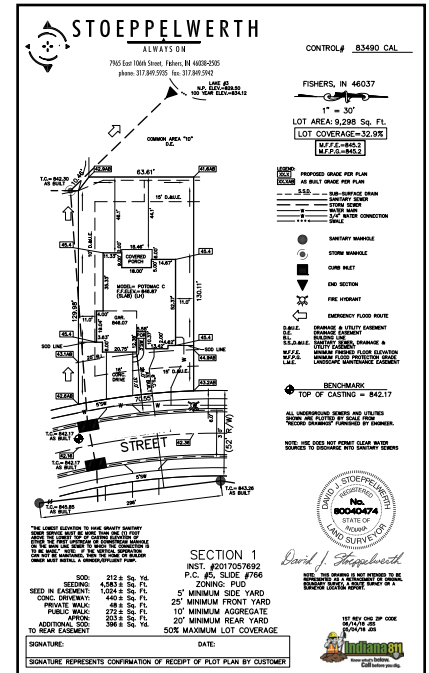

An example of a Residential Plot Plan.



NEED ASSISTANCE?

Planning staff is available Monday - Friday from 8:30 AM to 4:30 PM if you have any questions. Please use the contact info below.



Know what's below.
Call 811 before you dig or visit www.indiana811.org

"WHAT DO THESE LETTERS MEAN?"

Acronyms or abbreviations are commonly used on Plot / Site Plans. Here are commonly used ones and what they mean.

B.L. - Building Line	D.U. & S.E. - Drainage, Utility and Sanitary Easement
C.A.E. - Conservation Area Easement	F.M. - Force Main
CR. ACC. E. - Cross Access Easement	L.M.E. - Landscape Maintenance Easement
D.E. - Drainage Easement	R/W - Right of Way
D.E. & S.S.E. - Drainage Easement & Sanitary Sewer Easement	W - Water Line



Department of Planning & Zoning
Fishers Municipal Center
1 Municipal Drive Fishers, IN 46038
Email us at planning@fishers.in.us or call us at 317.595.3155